

2

1



INTEX[®]
MILLWORK SOLUTIONS

B

B

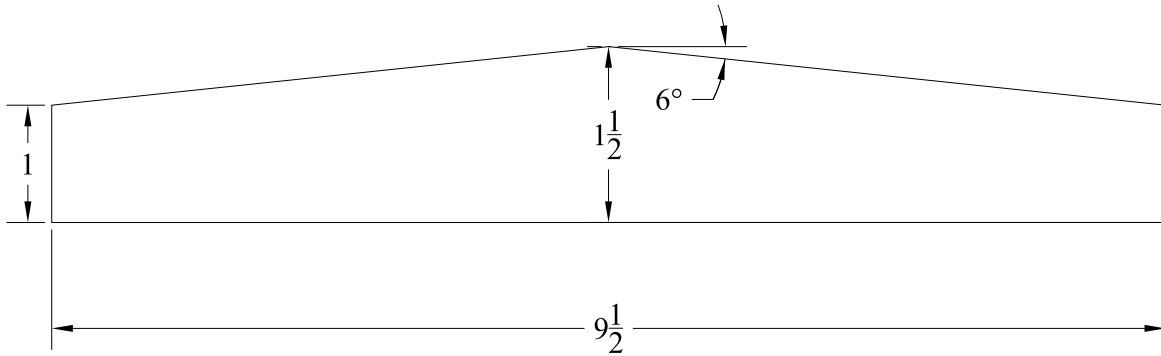

NOTE: A SHORT RUN SETUP CHARGE APPLIES TO ORDERS OF LESS THAN 20 PIECES

A

A

MATERIAL	CELLULAR PVC		NAME	DATE	DESCRIPTION
		DRAWN	XXX	XX-XX-XXXX	
FINISH	MATTE WHITE	CHECKED	XXX	XX-XX-XXXX	
LENGTH	17' 6"				
INTEX MILLWORK SOLUTIONS 45 MILL STREET MAYS LANDING, NJ 08330 PHONE: (856) 293-4100 FAX: (856) 293-4102		COMMENTS:			Beveled Wall Cap
		SIZE	DWG. NO.		
		A	IOM006		
					SHEET 1 OF 1

2

1